



ARES
INDUSTRIAL
MANAGEMENT

RIALTO COMMERCE CENTER

305 S. CEDAR AVENUE, RIALTO, CA 92376

FOR LEASE | ±198,334 SQ FT | Class A Warehouse Facility



Voit
REAL ESTATE SERVICES

NAI Capital

JUAN GUTIERREZ, SIOR

Executive Vice President
jgutierrez@voitco.com
909-545-8008
Lic.#01777990

SEAN SULLIVAN, SIOR

Senior Vice President
ssullivan@voitco.com
909-545-8004
Lic.#01980963

NICHOLAS CHANG, CCIM, SIOR

Executive Vice President
nchang@naicapital.com
909-243-7614
Lic#01344844

STEVE SCLIMENTI

Vice President
ssclimenti@naicapital.com
909-945-2339 x7638
Lic#01886028

DEVELOPED BY



ARES
INDUSTRIAL
MANAGEMENT

Property FEATURES

- ±198,334 SF Building
- ±3,476 SF Office
- 36' Ceiling Height
- ESFR Sprinkler System
- 1,200 amp with a 2,000 amp UGPS
- 2 (12' x 14') Grade Level Doors
- 26 (9' x 10') Dock High Doors
 - Ten (10) Doors with 35,000 lbs Pit Levelers
- 141 Auto Parking Stalls
- 41 Trailer Parking Stalls
- Secured Private Yard
- Spec LED Warehouse Lighting

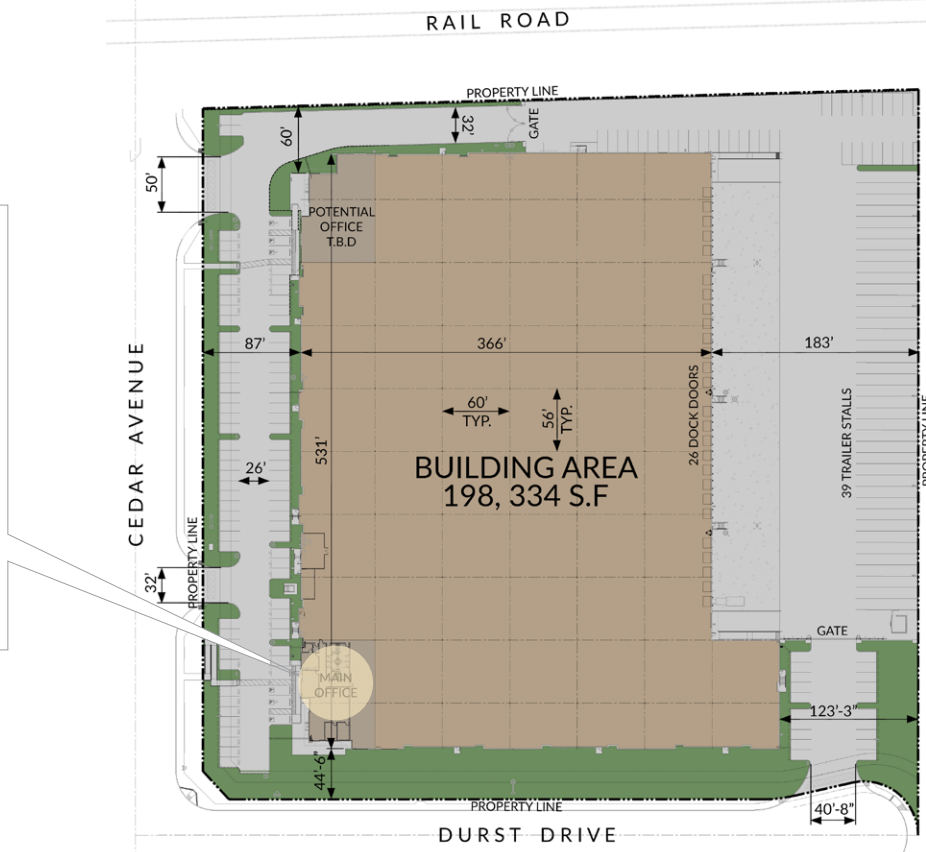

Location HIGHLIGHTS

- Direct access to the I-10 via the Cedar Avenue on/off ramp
- Centrally located in one of the premier distribution markets in the county
- 69 Miles from the Ports of LA and Long Beach
- 13 Miles from the Ontario International Airport
- 4 Miles from the Union Pacific Intermodal Yard
- 5 Miles from the BNSF Intermodal Yard
- Corporate Neighbors Include:
 - Amazon
 - Staples
 - UPS
 - FedEx



ARES
INDUSTRIAL
MANAGEMENT

ABOUT ARES MANAGEMENT CORPORATION

Ares Management Corporation (NYSE: ARES) is a leading global alternative investment manager providing clients complementary primary and secondary investment solutions across the credit, private equity, real estate and infrastructure asset classes. We seek to provide flexible capital to support businesses and create value for our stakeholders and within our communities. By collaborating across our investment groups, we aim to generate consistent and attractive investment returns throughout market cycles. For more information, please visit www.aresmgmt.com.



Voit
REAL ESTATE SERVICES

NAI Capital

JUAN GUTIERREZ, SIOR

Executive Vice President
jgutierrez@voitco.com
909-545-8008
Lic.#01777990

SEAN SULLIVAN, SIOR

Senior Vice President
ssullivan@voitco.com
909-545-8004
Lic.#01980963

NICHOLAS CHANG, CCIM, SIOR

Executive Vice President
nchang@naicapital.com
909-243-7614
Lic#01344844

STEVE SCLIMENTI

Vice President
ssclimenti@naicapital.com
909-945-2339 x7638
Lic#01886028

DEVELOPED BY



**ARES
INDUSTRIAL
MANAGEMENT**